

# FOR LEASE

Prime Robson Street Premise



1575 Robson Street, Vancouver, BC

- Corner location
- Great exposure
- Surface parking

Craig Haziza  
604.640.5891  
craig.haziza@ca.cushwake.com

 **CUSHMAN & WAKEFIELD**<sup>®</sup>  
Global Real Estate Solutions<sup>SM</sup>

# FOR LEASE

## Prime Robson Street Premise

### LOCATION

1575 Robson Street is located on the corner of Cardero and Robson Streets in the densely populated West End District in Vancouver.

Robson Street, an east/west thoroughfare connecting the Downtown district to the West End and Stanley Park, is the premier shopping street in Vancouver. With its hotels, specialty restaurants and boutique retail stores. Robson Street is a destination attraction for Vancouver's lucrative tourist trade and attracts shoppers from all districts in Vancouver.

### BUILDING

The premises is finished to an open plan showroom space on two levels. The space has excellent frontage on Robson with access from both Robson Street and the surface parking lot located behind the building.

### AVAILABLE UNIT

Ground floor	2,962 sf
Second floor	2,955 sf
Total	5,917 sf

### ASKING RENT

\$58.00	Ground floor
\$25.00	Second floor

### ADDITIONAL RENT (ESTIMATED 2010)

\$17.19 psf

### ZONING

C-6 (Commercial) Allowing for a wide variety of retail office, and restaurant uses.

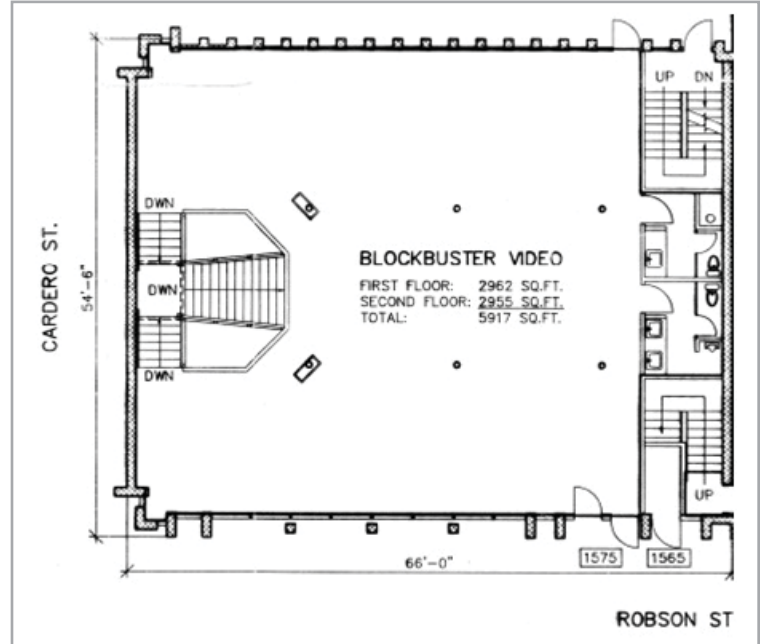
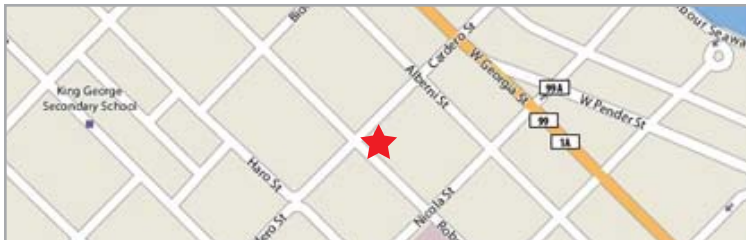

**Craig Haziza**  
604.640.5891  
craig.haziza@ca.cushwake.com

Cushman & Wakefield Ltd.  
Suite 700 - 700 West Georgia Street  
P.O. Box 10023, Pacific Centre  
Vancouver, BC V7Y 1A1  
T: 604.683.3111  
F: 604.683.0432  
TF: 1.877.788.3111  
www.cushmanwakefield.com  
www.vancouverlisting.ca

